

LEVEL 18 / FINANCIAL SERVICES

61,016 RSF

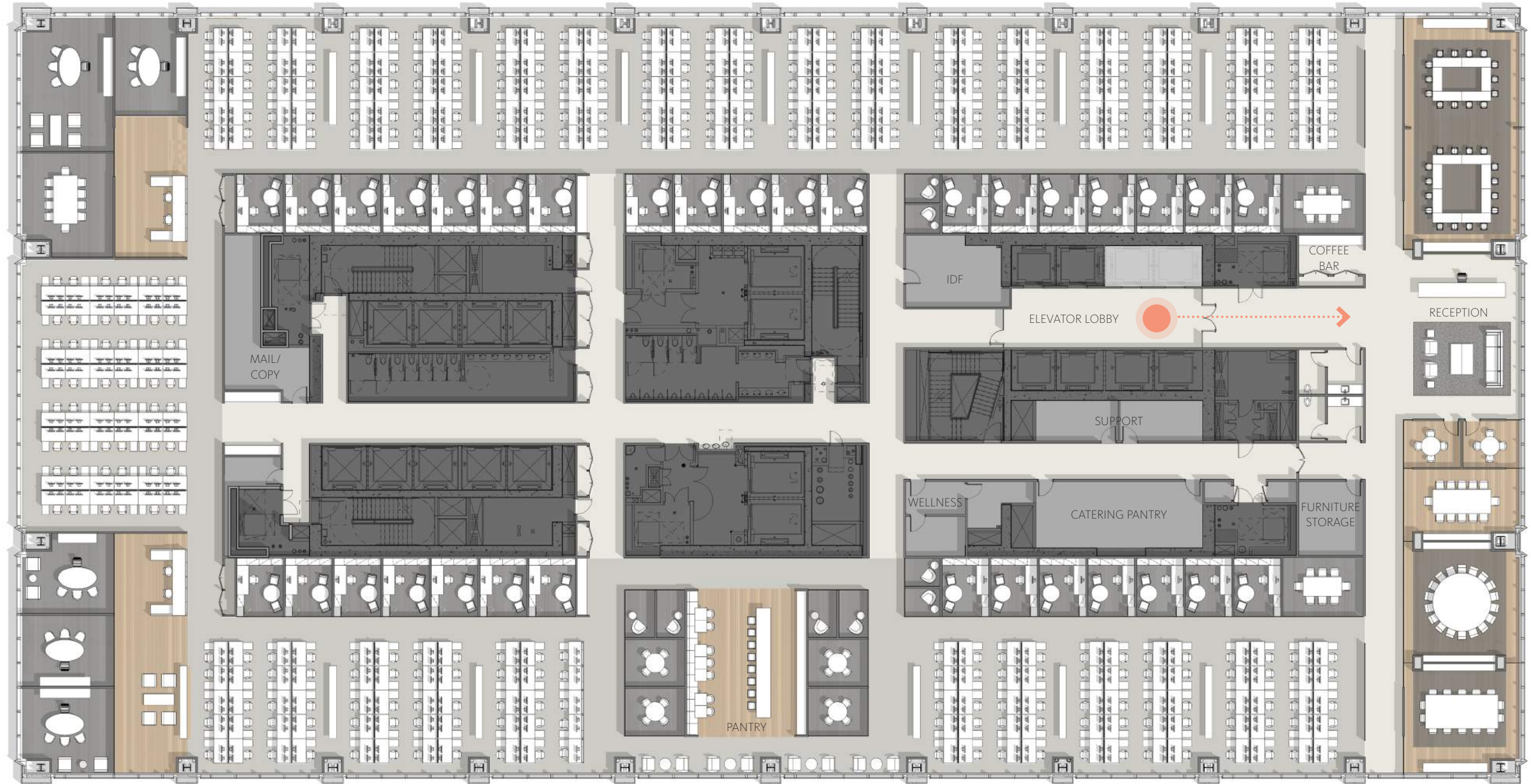
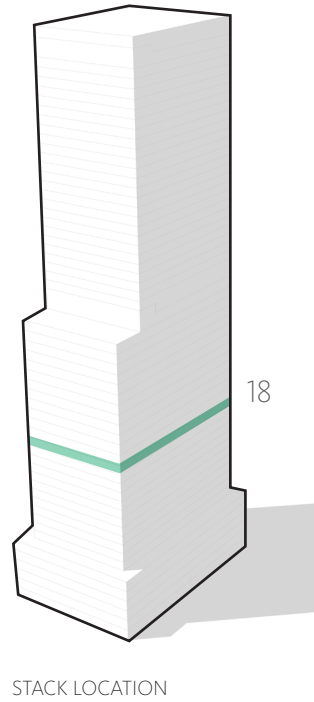

WORKPLACE METRICS	H.C.	%	RATIO
OFFICE	38	10	1
5' WORKSTATION	328	90	9
TOTAL	366		

167 RSF / PER PERSON



LEVEL 18 / LAW PRACTICE

61,016 RSF

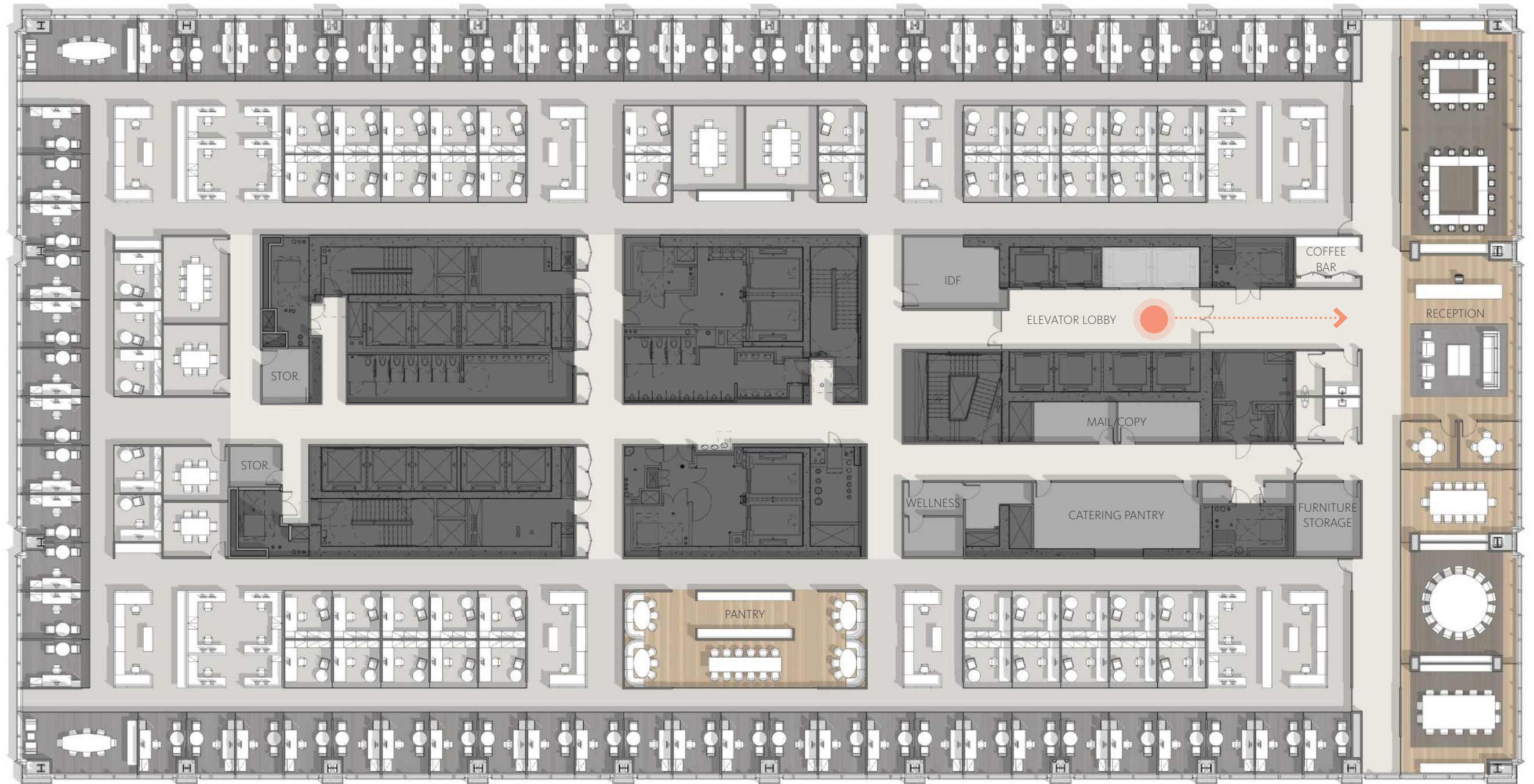
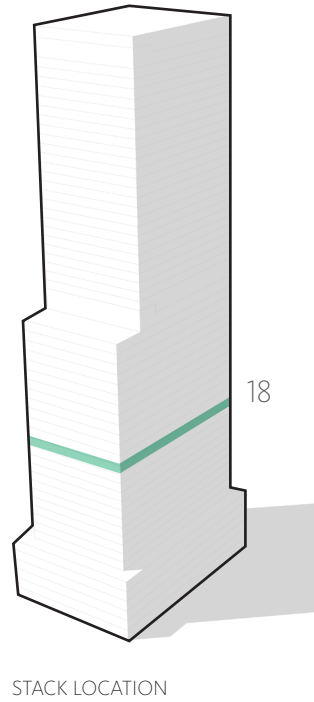

WORKPLACE METRICS	H.C.		H.C.	RATIOS
PARTNER	28	ADMIN	17	PARTNER : ASSOCIATE 1 : 3
PERIMETER ASSOCIATE	34	SUPPORT	18	ADMIN : ATTORNEY 1 : 6.5
COCKPIT ASSOCIATE	49	TOTAL	35	ATTORNEY : CONF. SEAT 1 : 1.25
TOTAL ATTORNEY	111	TOTAL HEADCOUNT	146	
550 RSF / ATTORNEY				



LEVEL 18 / TECH/CREATIVE

61,016 RSF

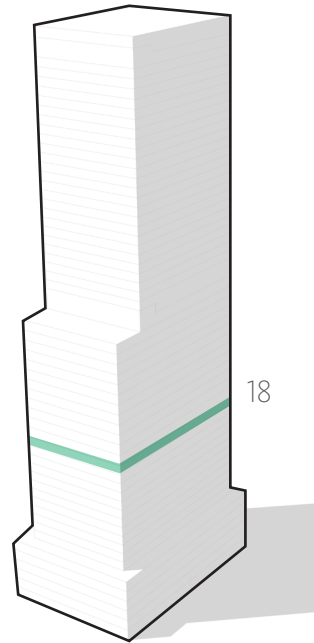

18

STACK LOCATION

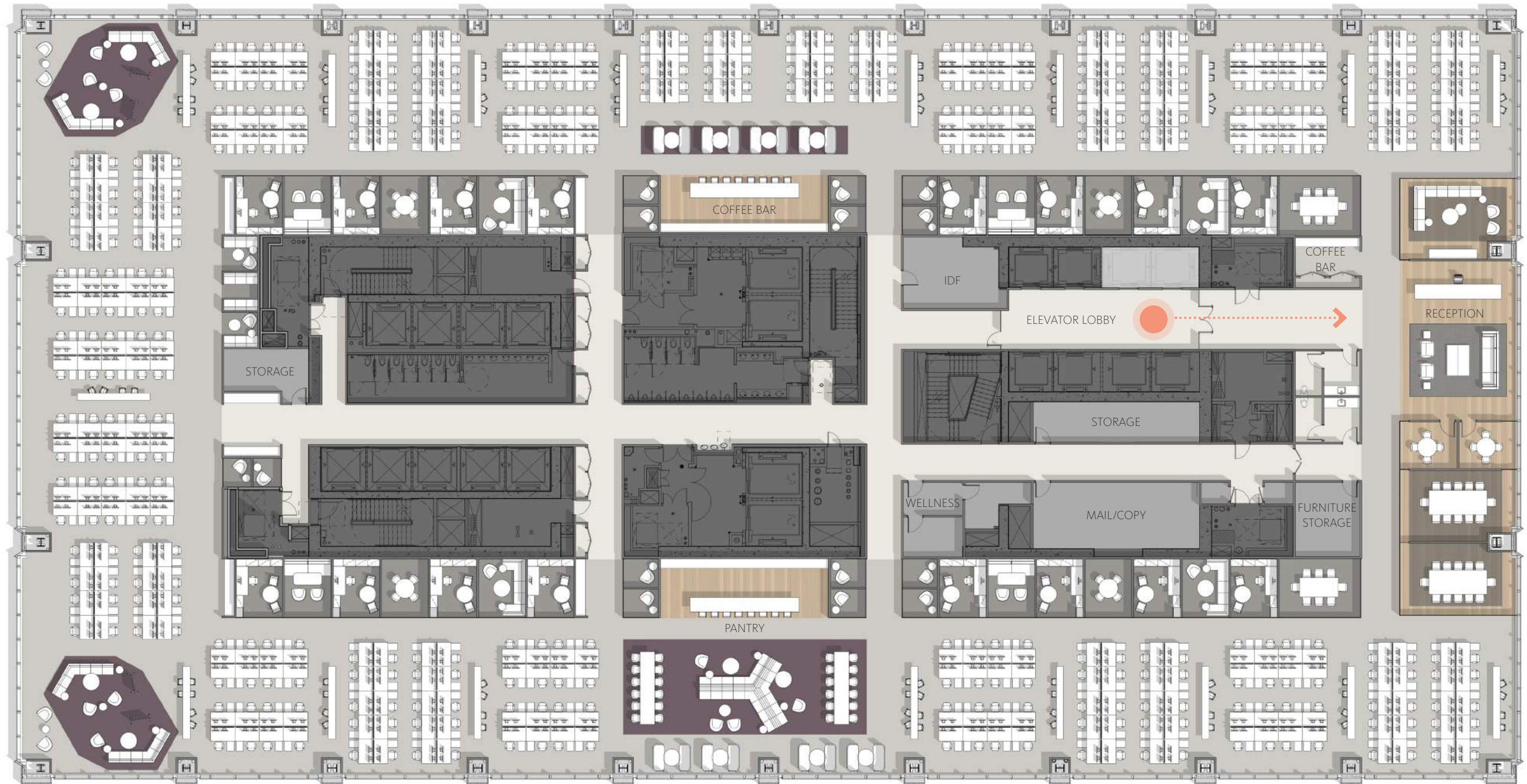

WORKPLACE METRICS		H.C.	SEAT COUNT	
OFFICE		16	ENCLOSED COLLABORATION	120
5' WORKSTATION		345	OPEN COLLABORATION	216
TOTAL		361	TOTAL	336

169 RSF / PER PERSON

